

2J5424P

CELLULAR / LTE Adhesive Mount

Key Features

CELLULAR / LTE

- 698-960 MHz
- 1710-2170 MHz
- 2500-2700 MHz

Adhesive Mount

Ultra Wide Band Antenna

Customizable Cable and Connector

Dimensions 112.5 x 60 x 11.3 mm



1. Antenna and electrical specifications

| Parameters | CELLULAR / LTE Antenna | | |
|-----------------------------|--|---------------------|-----------|
| Standards | 2G,3G and 4G | | |
| Band (MHz) | 700/850/900 | 1700/1800/1900/2100 | 2600 |
| Frequency (MHz) | 698-960 | 1710-2170 | 2500-2700 |
| Return Loss (dB) | ~-6.7 | ~-9.0 | ~-9.5 |
| VSWR | ~2.7:1 | ~2.1:1 | ~2.0:1 |
| Efficiency (%) | ~44 | ~49 | ~48 |
| Peak Gain (dBi) | ~1.8 | ~1.4 | ~2.1 |
| Average Gain (dB) | ~-3.6 | ~-3.1 | ~-3.2 |
| Impedance (Ohm) | 50 | | |
| Polarisation | Linear | | |
| Radiation Pattern | Omni-Directional | | |
| Max. Input Power (W) | 25 | | |
| Connector Type | Most RF Connectors (SMA-Male Standard) | | |
| Cable Length | Any Cable Length (300cm Standard) | | |
| Cable Type | Other Cables Available (LMR195 Standard) | | |

Antenna Measurement Conditions:

Mounted on 30 x 30 x 0.25 cm ABS Plate 200 cm LMR195 Cable
 Measured in Certified CTIA 3D Anechoic Chamber

2. Mechanical and environmental specifications

| Specifications | 2J5424P |
|----------------------------------|-------------------|
| Mounting Type | Adhesive Mount |
| Dimensions (mm) | 112.5 x 60 x 11.3 |
| Radome | PC/ABS UV Stable |
| Radome color | Black |
| Operating Temperature (C) | -40 to +85 |
| Storage Temperature (C) | -40 to +85 |
| Substance Compliance | RoHS |

3. Antenna parameters

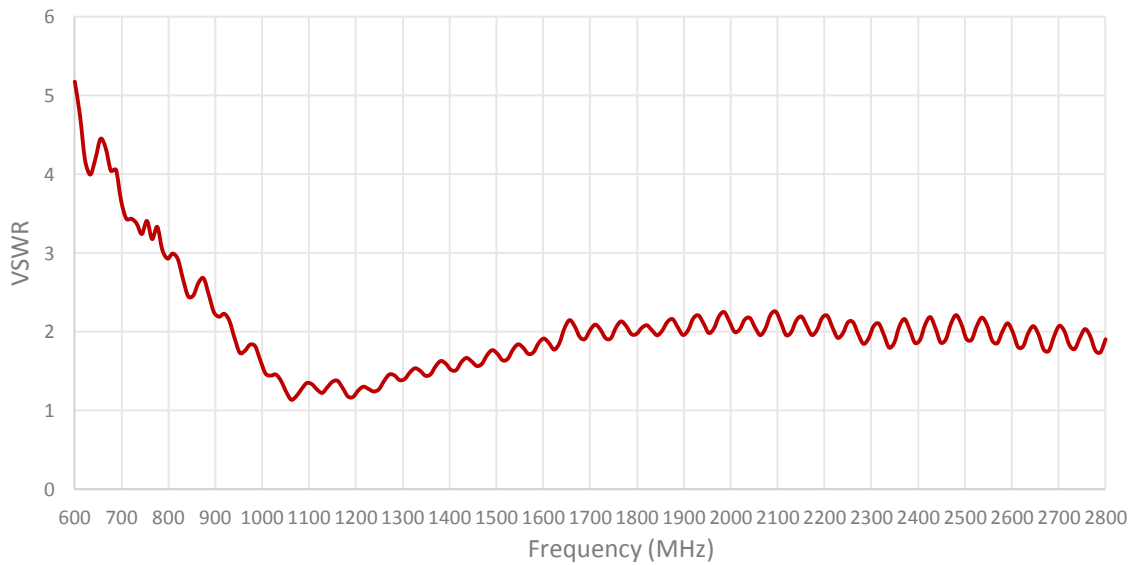
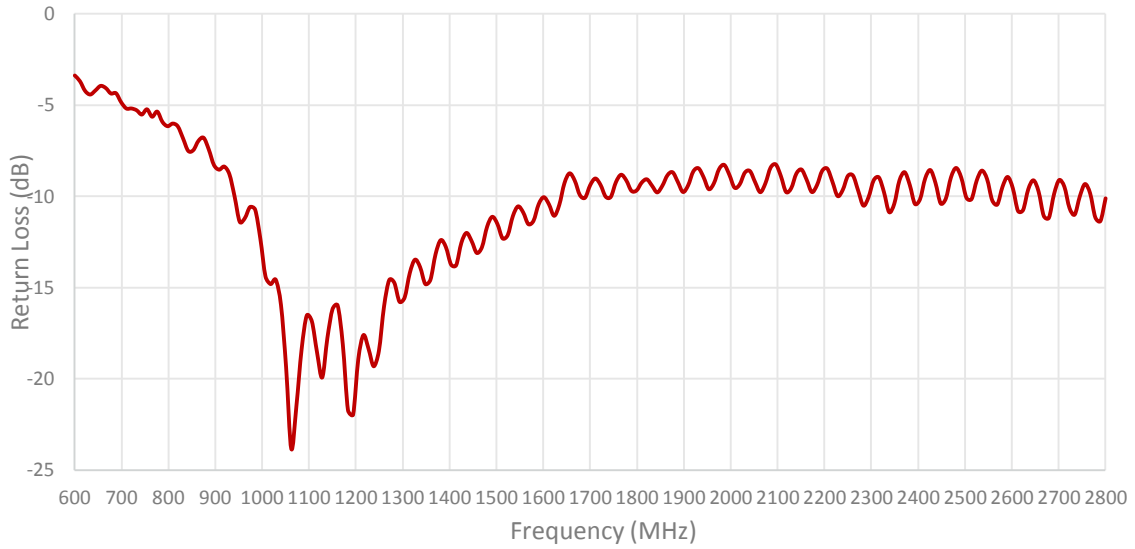

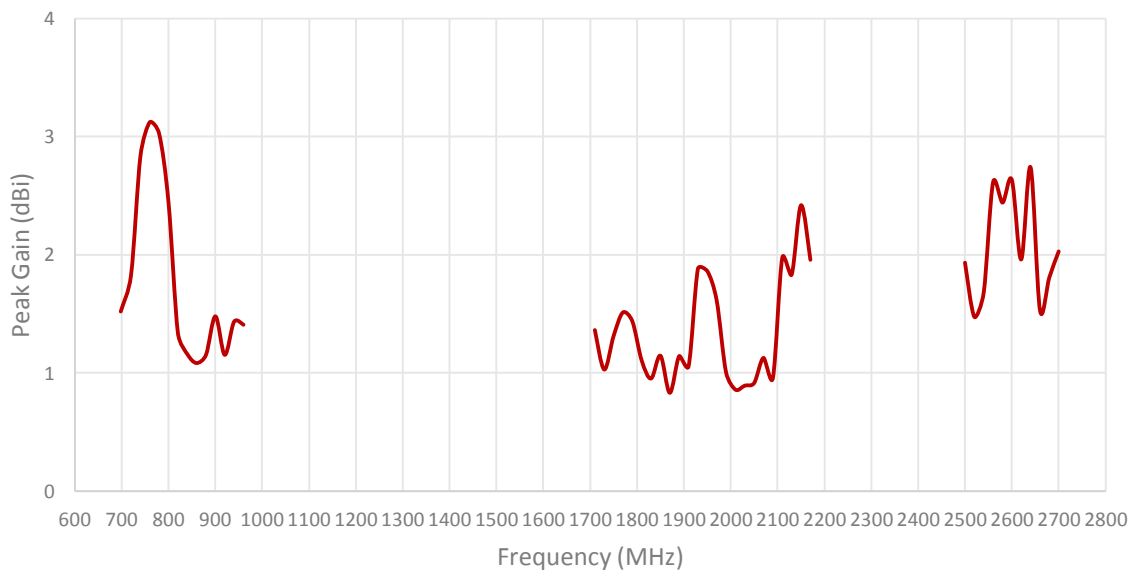
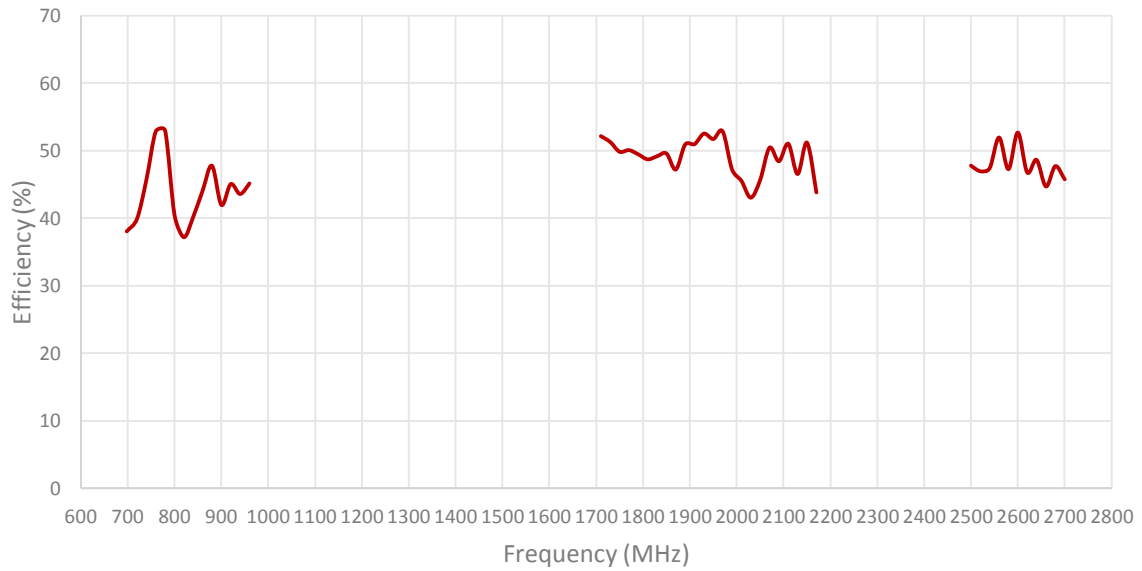

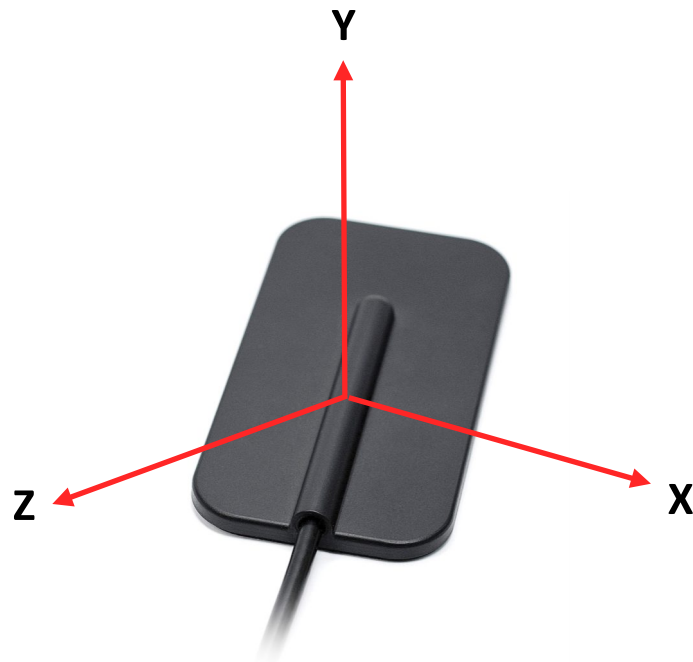
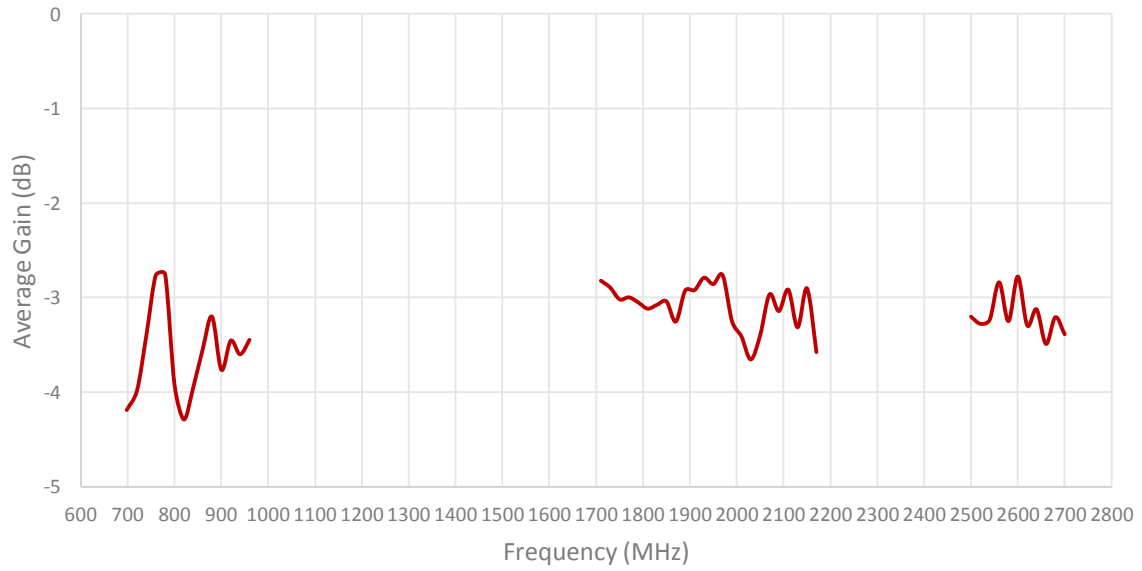

Radiation pattern reference

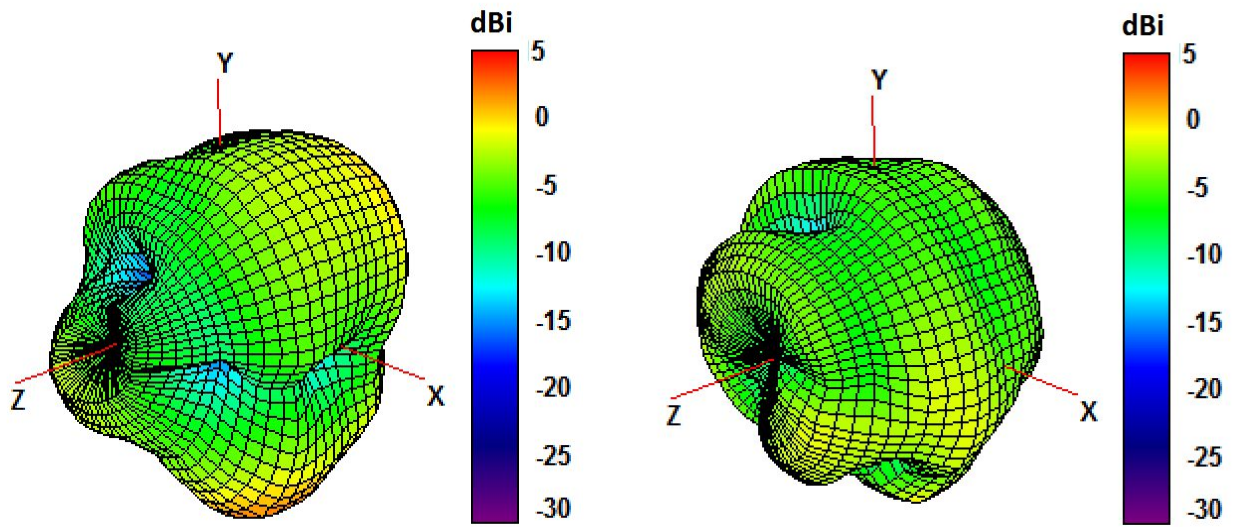

750 and 850 MHz Radiation pattern

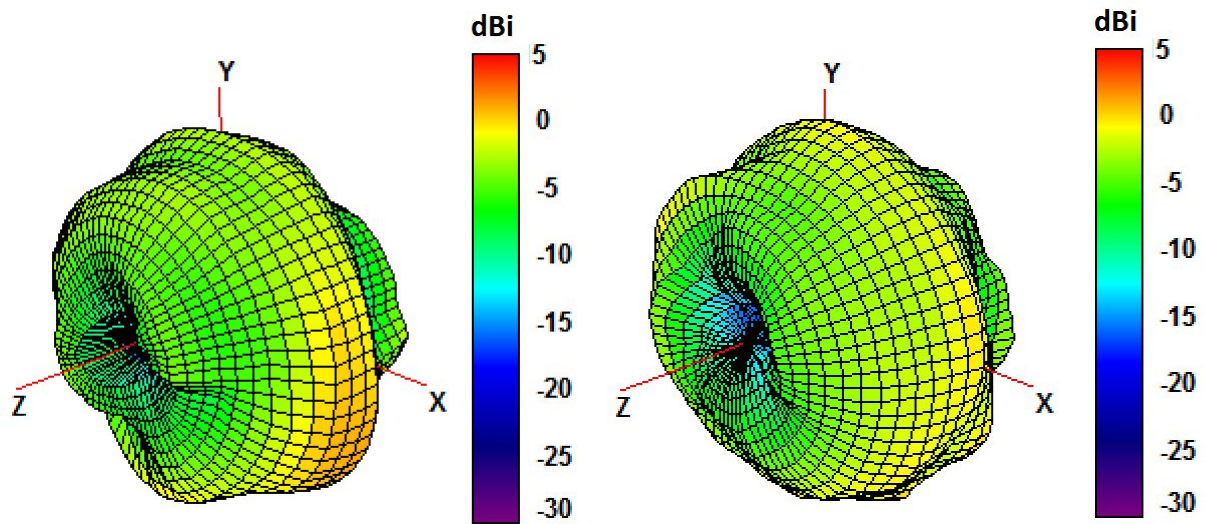

940 and 1750 MHz Radiation pattern

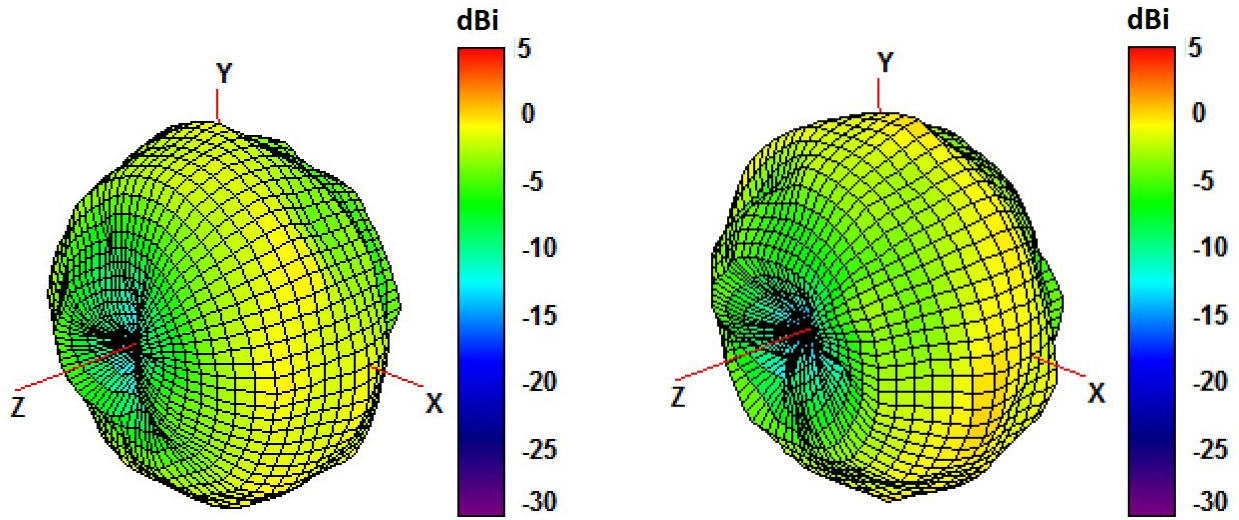

1850 and 1950 MHz Radiation pattern

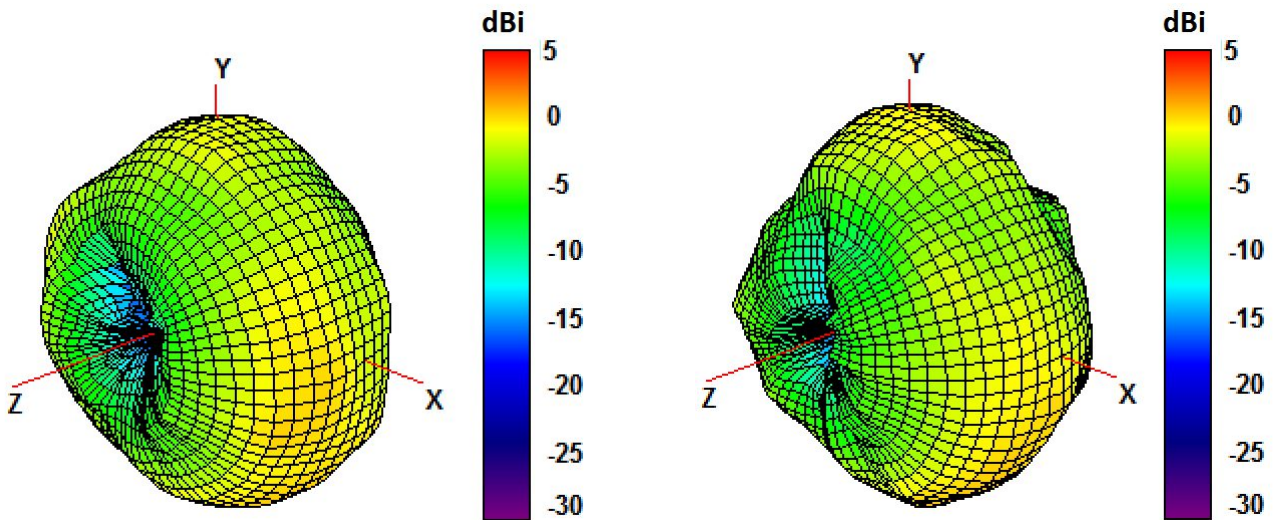

2100 and 2600 MHz Radiation pattern

4. Antenna drawings

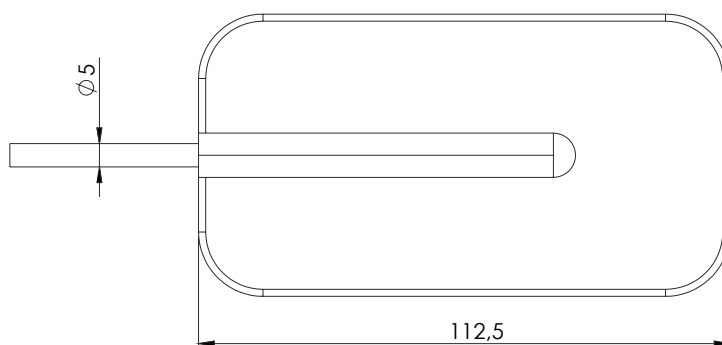
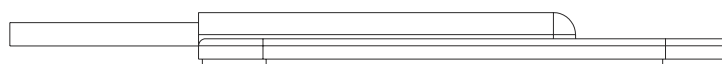
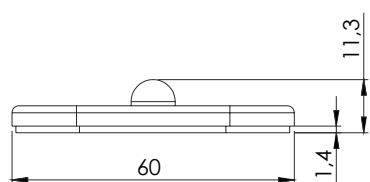

5. Antenna Images

